



DCL280F

LXT Cordless Cleaner

Powered by 18V Lithium-Ion battery

- High suction power
- Compact design
- Lightweight
- Quiet cleaning
- Less vibration

45W | **6.4kPa**
(Max Suction Power) | (Max Sealed Suction)

20minutes
continuous operation
(using 3.0Ah LXT battery)

Easy dust disposable



Ideal for residential & commercial spaces like schools, transport vehicles and home use



BRUSHLESS MOTOR

High suction power achieved with highly efficient Brushless motor



QUIET OPERATION | LOW VIBRATION

Ideal for noise sensitive areas

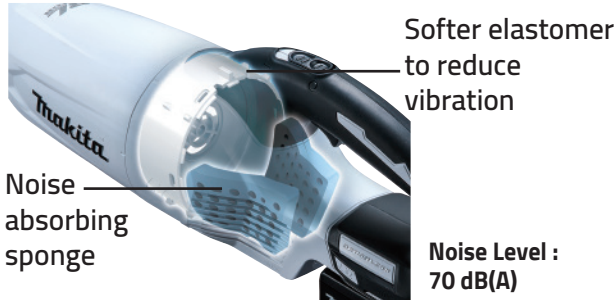

DURABILITY

Internal construction prevents loose installation of filter/paper dust bag to protect the motor room from dust.

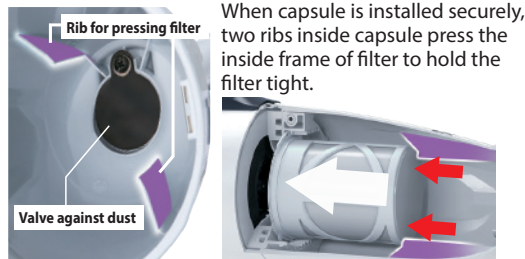

Trigger switch + Sliding lock-on switch

Allows for long continuous cleaning with less fatigue

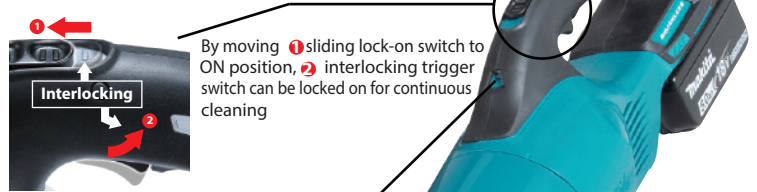

LED light illuminates the work area and acts as a low battery indicator

Pipe locking system Prevent the pipe from accidentally coming off

Pipe with beveled end Cleaning of tight places can be done without nozzle

SPECIFICATION

Capacity	750 mL
Continuous Use (min.)	20 minutes (with 3.0Ah battery)
Max Air Flow	1.4 m ³ /min
Max Sealed Suction	6.4 kPa
Suction Power	45W (with normal filter) / 40W (with shake-off filter)
Dimensions (L x W x H)	1,016x113x155 mm
Net weight	1.2 kg

FILTERS AND DUST BAGS

Note:- Easy shake-off filter is to be used with filter frame or Hepa filter

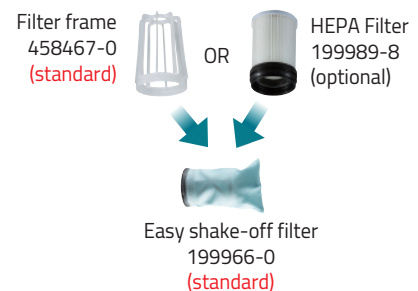

VARIANTS

VARIANTS	MODELS	COLOUR	BATTERY	CHARGER	CASE
BARE TOOL	DCL280FZ	BLUE	-	-	-

WIDE RANGE OF OPTIONAL ATTACHMENTS AVAILABLE

For various applications that include cleaning hard to reach places

STRAIGHT PIPE WITH LOCK

- 459356-2 (L=479) (standard)
- 1910Y3-1 (Telescopic, L=479-719mm)

FLEXIBLE HOSE

- 198541-9

FLEXIBLE HOSE WITH LOCK

- 191E30-3

SASH NOZZLE

- 451243-1 / 413859-0 (standard)
- 198990-0 (LONG)

ROUND BRUSH

- 198549-3

SHELF BRUSH

- 198534-6

RUBBER NOZZLE

- 197901-2

ANCHOR NOZZLE

- 192236-6
- Rubber nozzle is additionally required

NOZZLE ASSEMBLY

For floor / carpet (swivel type)

- 127827-4



For floor / carpet (with switch)

- 199431-9



For floor / carpet (with switch & swivel)

- 191G86-8



For floor

- 123488-8 (standard)



For rug / carpet

- 198523-1



Flat type

- 199454-7



Hard floor nozzle for narrow spaces

- 1911J4-0



Carpet nozzle for narrow spaces

- 1911J6-6



Seat nozzle For automobile

- 199040-4



CYCLONE UNIT

Designed to expand the capacity to collect debris.

- Powerful cyclonic action captures up to 90% of dust particles before entering the main dust box
- Reduces the frequency of emptying the main dust box
- One-touch release for easy disposal of debris



- 191D71-3
- With lock system (Optional)



COMPACT CYCLONE UNIT

Maintain the high performance (suction power) even if the filter is clogged

- 1910D4-2 (Optional)



Reach narrow spaces



Easy disposal of the fine dust



WALL BRACKET

Get the convenient storage by hanging the cleaner on the wall bracket

- 199971-7 (Optional)



STAND

- 1911L1-0 (optional)



Base can hold LXT charger and small accessories

BATTERY ADAPTER - BAP18C

Specially designed for use with 18V LXT cordless cleaners
Transfers the battery weight from the cleaner to user's waist to reduce the stress on hand

- 191M50-5 (optional)

