



VC3211HX1

Vacuum Cleaner / Dust Extractor  
(Wet & Dry)

**HIGH CLASS - Best in the range**  
**Self Cleaning Filtration System**



**GYUPPA!**  
Twin Filter

## Variable suction power control by dial

Suction power is variably adjustable to suit application or continuous rating input of connected power tool.



## Large capacity of on-board storage

Convenient for compact storage of:

- Hose
- Power supply cord



## For both Wet & Dry vacuum cleaning

Equipped with water level sensor

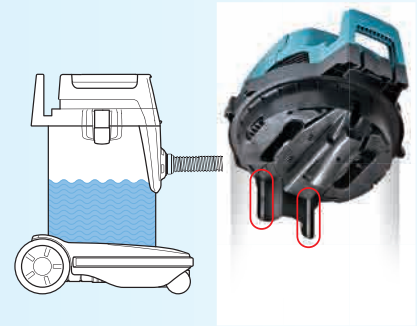

Flat top design allows double stacking for stable and space saving storage.

Durable latch of plate steel with elastomer lock lever for easy locking/unlocking operation

Large rear wheels for added mobility and stability

Air flow sensor emits warning beeps when air flow is reduced by clogged filter, near full tank, etc.



## Compatible with commercially available poly bags, allowing for:

- Quick and easy dust disposal
- Lower-running cost compared with paper dust bag



## Base hook

Convenient for compact storage of:  
Front cuffs, Hose, Power supply cord



## Large capacity of on-board storage



## Caster stopper

prevents the vacuum cleaner from moving unintentionally during use with power tool or intermission of operation.

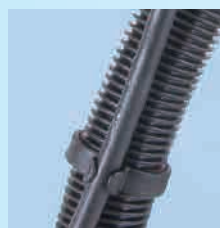

## Hose band

ties the air hose and a power supply cord of a connecting power tool together for added maneuverability.

## Specification

<b>Continuous rating Input</b>	1,050W
<b>Max. peak air flow</b>	2.0m <sup>3</sup> / min (with Hose complete 28-3.5) 3.5m <sup>3</sup> / min (with Hose complete 38-2.5)
<b>Max. sealed suction</b>	22.0kPa
<b>Tank capacity</b>	Dust : 32L / Water : 27L
<b>Dimensions (L x W x H)</b>	552x398x685mm
<b>Net Weight</b>	16.9kg
<b>Power supply cord</b>	5.0m

**Standard Equipments:** Hose 38mm 2.5m, Hose 28mm 2.5m, bend pipe, straight pipe, corner nozzle, front cuff 22, 38, 24 poly bag 10pcs

- Electronic 2-Speed
- Revolving Hose
- Static Free Hose
- Variable Speed
- Stainless Tank

# New Automatic Self-cleaning Filtration System achieved by two triple structure filter units composed of Powder filter, Damper and Prefilter

- Constant high suction power throughout operation because dust is removed from the Prefilters every 10 seconds during operation.
- Easy filter cleaning simply by tapping dust off of Prefilter
- Quiet cleaning because Damper and Prefilter make no noise.



## Suctioning (L & R)

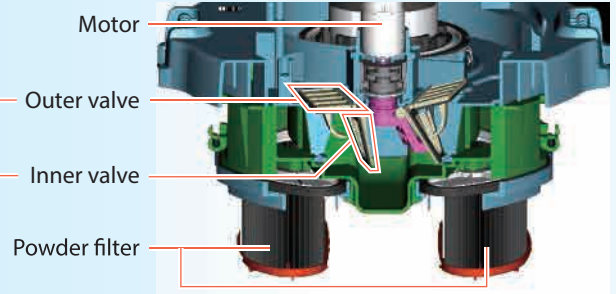
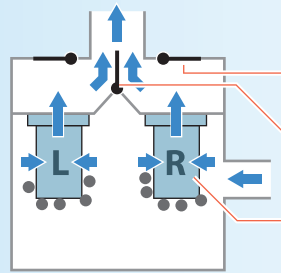

1) When switched on, the machine starts vacuum operation using two filter units, and each Prefilter of the two filter units collapses into itself to compress Damper, and fits closely over Damper and Powder filter.



## Self-cleaning (L)

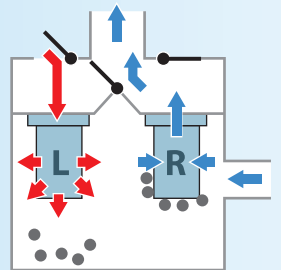

2) About 10 seconds after, the vacuum air flow toward one of the two filter units is automatically reversed by air flow control valves engaged with a DC motor powered cam, then the air blast forcibly expands compressed Damper to shake off dust from the Prefilter while the vacuum operation continues using the other filter unit.



## Self-cleaning (R)

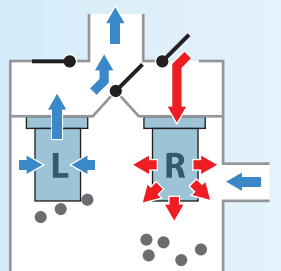

3) Immediately after 2), the other filter unit is automatically cleaned through the same mechanism as in 2) while the machine continues vacuum operation.

4) Again, the machine starts vacuum operation using two filter units.



## CLEANING ATTACHMENTS

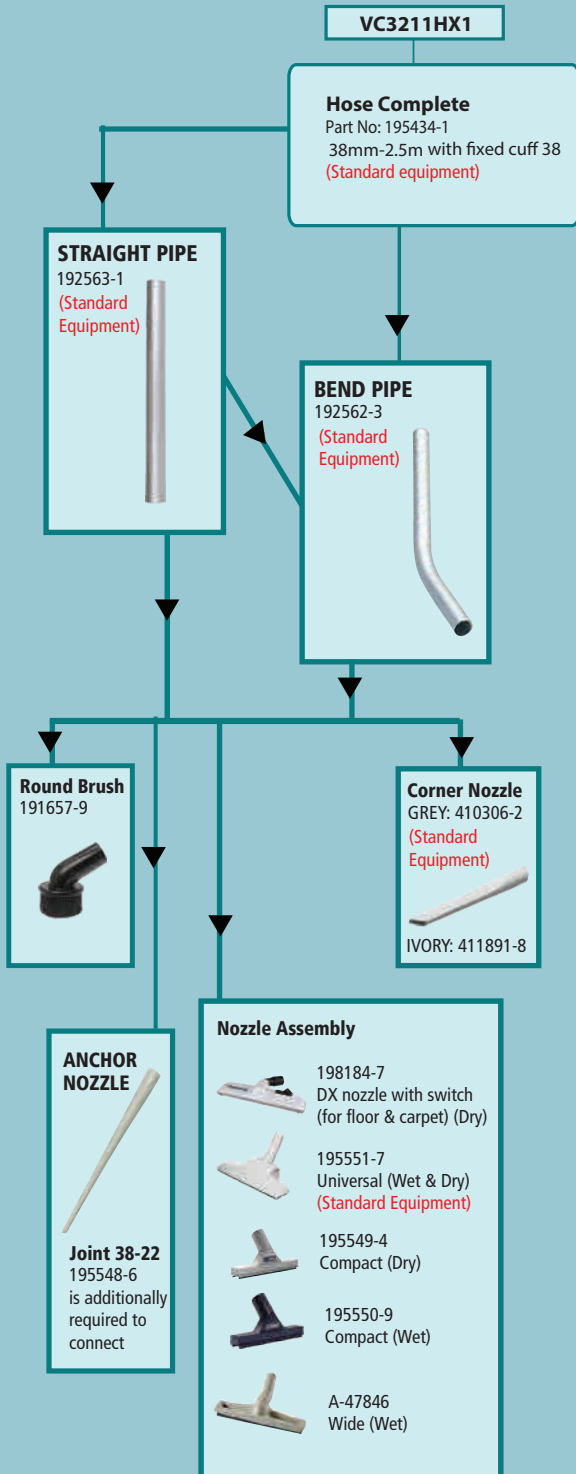

## FILTERS & OTHER ACCESSORIES

**Powder Filter Set**  
Dry only



Part no: 196251-2  
(Standard equipment)

**Pre-filter set**



Part no: 196253-8  
(Standard equipment)

**Damper set**



Part no: 196254-6  
(Standard equipment)

**Filter bag set 25L**  
(5pcs) for dry dust



Part no: 195558-3

**Poly bag set**  
(10pcs)



Part no: 195440-6  
(Standard equipment)

**MAKPAC adapter set**

Makita AC Vacuum Cleaner to connect with MAKPAC

Part No.  
198730-6

For Model No.  
VC3211H  
VC3210L



## DUST EXTRACTION ATTACHMENTS

Please refer the cleaner catalogue:  
[Download Cleaner Catalogue](#)



**Simple connection to Makita power tools**

Vacuum cleaner turns on or off automatically when connected power tool is turned on or off.

Before connecting make sure to observe the maximum connected loads for the appliance socket (Refer to the instruction manual.)

**Makita**

**Makita Gulf FZE**

www.makita.ae