

Keep the battery dry.
Use the battery away from children.
Do not use in maintaining equipment.
Charge the battery cartridge before completely discharged. Always stop tool operation and charge the battery cartridge when you notice less power.
Never use the battery cartridge in a wet or damp environment. Always charge the battery cartridge with the battery cartridge charger. Do not charge the battery cartridge with room temperature at 10 °C - 40 °C (50 °F - 104 °F). Let us hot battery cartridge cool down before charging it.
When not using the battery cartridge, remove it from the tool or charger.
Charge the battery cartridge if you do not use it for a long period (more than six months).

SAVE THESE INSTRUCTIONS
CAUTION: Only use genuine Makita batteries. Use of non-genuine Makita batteries, or batteries that have been altered, may result in the battery bursting causing personal injury and fire.
This is only the Makita warranty for the Makita tool and charger.

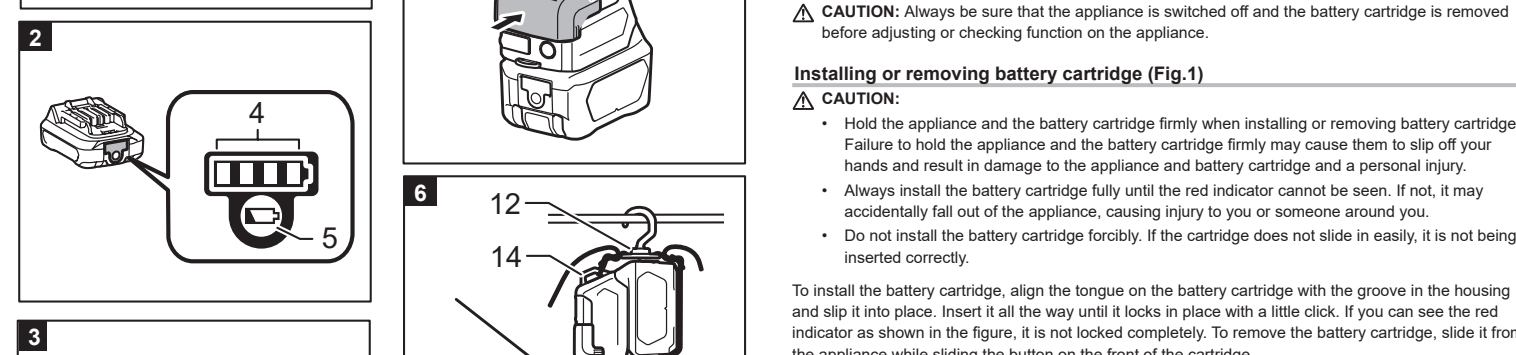

FUNCTIONAL DESCRIPTION
CAUTION: Always be sure that the appliance is switched off and the battery cartridge is removed before adjusting or checking/locking on the appliance.
CAUTION: Hold the appliance and the battery cartridge firmly when installing or removing battery cartridge. 2. Failure to hold the appliance firmly may cause them to slip off your hands and result in damage to the appliance and battery cartridge and a personal injury.
Always install the battery cartridge fully until the red indicator cannot be seen. If not, it may accidentally fall out of the appliance and cause personal injury to you or someone around you.
Do not insert the battery cartridge forcefully. If the cartridge does not slide in easily, it is not being installed correctly.
To install the battery cartridge, slip the tongue on the battery cartridge with the groove in the housing and insert it into place. Insert it all the way until it locks in place with a click. If you can see the red indicator as shown in figure 1, it is not locked completely. Use the battery cartridge, slide it to the appliance while holding the front of the cartridge.

Indicating the remaining battery capacity (Fig. 2)
Press the check button on the battery cartridge to indicate the remaining battery capacity. The indicator lamp lights up for a few seconds.

NOTE:
1. When the left indicator lamp will blink when the battery protection system works.
2. When the two on the left side and two on the right side of the indicator lamps light up alternately, the battery may have malfunctioned.

Overcharge protection
When the battery capacity is not enough, the appliance stops automatically. In this case, remove the battery from the appliance and charge the battery.

Protections against other causes
Protection system is also designed for other causes that could damage the appliance and allows the appliance to stop automatically. Take all the following steps to discover the causes when the appliance has been brought to a temporary halt of stop in operation.
1. Turn the appliance OFF, and then turn it on again to restart.
2. Change the battery cartridge (if replace) (battery with recharged battery).3. Turn off the appliance and battery pack's cool down.
If no improvement can be found by restoring protection system, then contact your local Makita Service Center.

Lighting up the light (Fig. 3)
CAUTION: Do not touch the light or see the source of light directly.
1. Press the power switch.
2. Press and hold the light switch to turn on the light. Press the switch button again to turn the light in USB power mode before turning it off.
Press and hold the light switch to turn on the light. Press the switch button again to turn the light in USB power mode before turning it off.

Connecting USB devices (Fig. 4)
CAUTION:
Connect only USB devices which are compatible with the USB power supply port, otherwise it may cause damage to the device.
Do not use a damaged USB cable.
Do not insert metal, wires, or other items into the USB power supply port. Doing so may cause short circuit, which may cause smoke or a fire.
Do not put the USB cable in your mouth.

Applicable battery charger and charger
Battery charger: BL1016, BL1021B, BL1041B
Charger: DC105A, DC105B, DC105C, DC105D, DC105E
Use the battery charger/cables that are available in the region of residence.
WARNING: Only use the battery chargers listed above. Use of any other battery chargers and cables may cause injury and/or fire.

IMPORTANT SAFETY INSTRUCTIONS
WARNING: When using appliances, basic safety precautions should always be followed to minimize the risk of fire, electric shock, and personal injury, including the following:
1. Do not look into the light, or do not expose the light to eyes. Eyes may be damaged.
2. Do not cover the lamp with cloth or curtain, etc. Otherwise it may cause a fire.
3. Do not use the tool in wet weather. Do not use it in wet locations. Do not expose it to rain or snow. Do not work in it in water.
4. Do not touch the inside of appliance with wet hands. Wet hands may be shocked, metal tools, etc.
5. When the appliance is not in use, always switch it off and remove the battery cartridge from the appliance.
6. Do not use the tool in any way, always work on or falling plane, etc. at level. Be surface or secure it on a stable surface. Do not give the appliance a shock by dropping, striking, etc.
7. Safety information for portable luminaires with batteries.
8. Batteries should be used in compliance with your local regulations that address the disposal of hazardous materials for luminaires.
9. Do not incinerate the battery.
10. Do not use the battery in a way that is not intended for use.
11. The light source of this luminaire is not replaceable, when the light source reaches its end of life the luminaire shall be replaced.
12. Do not use the luminaire in a way that is not intended for use.
13. **WARNING:** Read all safety instructions and instructions. Failure to follow the warnings and instructions may result in electric shock, fire and/or serious injury.
14. Review the manual thoroughly. Do not use it in a position before contacting to battery pack, picking up or carrying the appliance. Charge the appliance with your finger on the switch or emergency stopping button that has the switch on inverse accents.
15. Use appropriate maintenance and repair instructions for the appliance before making any adjustments, changing accessories, or storing appliances. Such preventive safety measures reduce the risk of starting the appliance, or storing appliances.
16. Recharge only with the charger specified by the manufacturer. A charger that is suitable for one type of battery pack may create a risk of fire when used with another battery pack.
17. Use appropriate maintenance and repair instructions for the appliance before making any adjustments, changing accessories, or storing appliances. Such preventive safety measures reduce the risk of starting the appliance, or storing appliances.
18. When battery pack is not in use, keep it away from other electrical objects, like paper clips, coins, keys, nails, screws or other small metal objects. Do not store a battery pack on one terminal or another.
19. Under above conditions, liquid may be emitted from the battery, avoid contact. If contact accidentally occurs, flush with water. If liquid contacts eyes, additionally seek medical help. Liquid ejected from the battery may cause irritation or burns.
20. Do not use a battery pack or appliance that is damaged or modified. Damaged or modified tools may present the hazard of personal injury resulting in fire, explosion or risk of electric shock.
21. Do not expose a battery pack or appliance to fire or for excessive temperature. Exposure to fire or temperature above 150 °C (305 °F) may cause explosion.
22. Follow all charging instructions and do not charge the battery pack or appliance outside of the temperature range specified in the instructions. Charging improperly or at temperatures outside of the specified temperature range may damage the battery and the appliance.
23. Have servicing performed by a qualified repair person using only identical replacement parts. This will ensure that the safety of the product is maintained.
24. Do not touch the inside of the appliance or the battery cartridge except as indicated in the instructions for use and care.
25. Important safety instructions for battery charging:
26. Before the battery cartridge, read all instructions and cautionary markings on (1) battery charger, (2) battery and (3) product using battery.
27. Do not disassemble or tamper with the battery cartridge. If any result in a fire, excessive heat, or explosion, immediately seek medical help.
28. Do not use a damaged battery.

REAL-ALL INSTRUCTIONS.
1. Do not look into the light, or do not expose the light to eyes. Eyes may be damaged.
2. Do not cover the lamp with cloth or curtain, etc. Otherwise it may cause a fire.
3. Do not use the tool in wet weather. Do not use it in wet locations. Do not expose it to rain or snow. Do not work in it in water.
4. Do not touch the inside of appliance with wet hands. Wet hands may be shocked, metal tools, etc.
5. When the appliance is not in use, always switch it off and remove the battery cartridge from the appliance.
6. Do not use the tool in any way, always work on or falling plane, etc. at level. Be surface or secure it on a stable surface. Do not give the appliance a shock by dropping, striking, etc.
7. Safety information for portable luminaires with batteries.
8. Batteries should be used in compliance with your local regulations that address the disposal of hazardous materials for luminaires.
9. Do not incinerate the battery.
10. Do not use the battery in a way that is not intended for use.
11. The light source of this luminaire is not replaceable, when the light source reaches its end of life the luminaire shall be replaced.
12. Do not use the luminaire in a way that is not intended for use.
13. **WARNING:** Read all safety instructions and instructions. Failure to follow the warnings and instructions may result in electric shock, fire and/or serious injury.
14. Review the manual thoroughly. Do not use it in a position before contacting to battery pack, picking up or carrying the appliance. Charge the appliance with your finger on the switch or emergency stopping button that has the switch on inverse accents.
15. Use appropriate maintenance and repair instructions for the appliance before making any adjustments, changing accessories, or storing appliances. Such preventive safety measures reduce the risk of starting the appliance, or storing appliances.
16. Recharge only with the charger specified by the manufacturer. A charger that is suitable for one type of battery pack may create a risk of fire when used with another battery pack.
17. Use appropriate maintenance and repair instructions for the appliance before making any adjustments, changing accessories, or storing appliances. Such preventive safety measures reduce the risk of starting the appliance, or storing appliances.
18. When battery pack is not in use, keep it away from other electrical objects, like paper clips, coins, keys, nails, screws or other small metal objects. Do not store a battery pack on one terminal or another.
19. Under above conditions, liquid may be emitted from the battery, avoid contact. If contact accidentally occurs, flush with water. If liquid contacts eyes, additionally seek medical help. Liquid ejected from the battery may cause irritation or burns.
20. Do not use a battery pack or appliance that is damaged or modified. Damaged or modified tools may present the hazard of personal injury resulting in fire, explosion or risk of electric shock.
21. Do not expose a battery pack or appliance to fire or for excessive temperature. Exposure to fire or temperature above 150 °C (305 °F) may cause explosion.
22. Follow all charging instructions and do not charge the battery pack or appliance outside of the temperature range specified in the instructions. Charging improperly or at temperatures outside of the specified temperature range may damage the battery and the appliance.
23. Have servicing performed by a qualified repair person using only identical replacement parts. This will ensure that the safety of the product is maintained.
24. Do not touch the inside of the appliance or the battery cartridge except as indicated in the instructions for use and care.
25. Important safety instructions for battery charging:
26. Before the battery cartridge, read all instructions and cautionary markings on (1) battery charger, (2) battery and (3) product using battery.
27. Do not disassemble or tamper with the battery cartridge. If any result in a fire, excessive heat, or explosion, immediately seek medical help.
28. Do not use a damaged battery.

Warm color light (Fig. 5)
A detachable cover to light lens part for changing light output to warm color with high relation effect.
Strip with tool (Fig. 6)Safety information for portable luminaires with batteries.
Batteries should be used in compliance with your local regulations that address the disposal of hazardous materials for luminaires.
Do not use the battery in a way that is not intended for use.
Do not touch the luminaire or the tool immediately after use as it may get hot enough to cause burns.
Do not allow chips, dust, or soil such as dirt on the terminals, holes, and grooves of the battery cartridge. If any result in poor performance or breakdown of the tool or battery cartridge.
Unless the tool supports the use of high-voltage electrical power, it may result in a malfunction or breakdown of the tool or high-voltage electrical power lines. It will cause a fire, explosion or other damage to the tool.

English (Original Instructions)
Explanation of general view
1. Battery cartridge 2. Red indicator 3. Button 4. Indicator lamp 5. Check button 6. Light switch 7. Top LED 8. Side LED 9. USB power 10. Power switch 11. Power switch 12. Top LED (4 pins) 13. Ring 14. Side hole 15. All LED 16. Side LED 17. Ring 18. Side LED (4 pins) 19. USB power 20. Power switch 21. Power switch 22. Top LED (4 pins) 23. Ring 24. Side hole 25. All LED 26. Side LED 27. Ring 28. Side LED (4 pins) 29. USB power 30. Power switch 31. Power switch 32. Top LED (4 pins) 33. Ring 34. Side hole 35. All LED 36. Side LED 37. Ring 38. Side LED (4 pins) 39. USB power 40. Power switch 41. Power switch 42. Top LED (4 pins) 43. Ring 44. Side hole 45. All LED 46. Side LED 47. Ring 48. Side LED (4 pins) 49. USB power 50. Power switch 51. Power switch 52. Top LED (4 pins) 53. Ring 54. Side hole 55. All LED 56. Side LED 57. Ring 58. Side LED (4 pins) 59. USB power 60. Power switch 61. Power switch 62. Top LED (4 pins) 63. Ring 64. Side hole 65. All LED 66. Side LED 67. Ring 68. Side LED (4 pins) 69. USB power 70. Power switch 71. Power switch 72. Top LED (4 pins) 73. Ring 74. Side hole 75. All LED 76. Side LED 77. Ring 78. Side LED (4 pins) 79. USB power 80. Power switch 81. Power switch 82. Top LED (4 pins) 83. Ring 84. Side hole 85. All LED 86. Side LED 87. Ring 88. Side LED (4 pins) 89. USB power 90. Power switch 91. Power switch 92. Top LED (4 pins) 93. Ring 94. Side hole 95. All LED 96. Side LED 97. Ring 98. Side LED (4 pins) 99. USB power 100. Power switch 101. Power switch 102. Top LED (4 pins) 103. Ring 104. Side hole 105. All LED 106. Side LED 107. Ring 108. Side LED (4 pins) 109. USB power 110. Power switch 111. Power switch 112. Top LED (4 pins) 113. Ring 114. Side hole 115. All LED 116. Side LED 117. Ring 118. Side LED (4 pins) 119. USB power 120. Power switch 121. Power switch 122. Top LED (4 pins) 123. Ring 124. Side hole 125. All LED 126. Side LED 127. Ring 128. Side LED (4 pins) 129. USB power 130. Power switch 131. Power switch 132. Top LED (4 pins) 133. Ring 134. Side hole 135. All LED 136. Side LED 137. Ring 138. Side LED (4 pins) 139. USB power 140. Power switch 141. Power switch 142. Top LED (4 pins) 143. Ring 144. Side hole 145. All LED 146. Side LED 147. Ring 148. Side LED (4 pins) 149. USB power 150. Power switch 151. Power switch 152. Top LED (4 pins) 153. Ring 154. Side hole 155. All LED 156. Side LED 157. Ring 158. Side LED (4 pins) 159. USB power 160. Power switch 161. Power switch 162. Top LED (4 pins) 163. Ring 164. Side hole 165. All LED 166. Side LED 167. Ring 168. Side LED (4 pins) 169. USB power 170. Power switch 171. Power switch 172. Top LED (4 pins) 173. Ring 174. Side hole 175. All LED 176. Side LED 177. Ring 178. Side LED (4 pins) 179. USB power 180. Power switch 181. Power switch 182. Top LED (4 pins) 183. Ring 184. Side hole 185. All LED 186. Side LED 187. Ring 188. Side LED (4 pins) 189. USB power 190. Power switch 191. Power switch 192. Top LED (4 pins) 193. Ring 194. Side hole 195. All LED 196. Side LED 197. Ring 198. Side LED (4 pins) 199. USB power 200. Power switch 201. Power switch 202. Top LED (4 pins) 203. Ring 204. Side hole 205. All LED 206. Side LED 207. Ring 208. Side LED (4 pins) 209. USB power 210. Power switch 211. Power switch 212. Top LED (4 pins) 213. Ring 214. Side hole 215. All LED 216. Side LED 217. Ring 218. Side LED (4 pins) 219. USB power 220. Power switch 221. Power switch 222. Top LED (4 pins) 223. Ring 224. Side hole 225. All LED 226. Side LED 227. Ring 228. Side LED (4 pins) 229. USB power 230. Power switch 231. Power switch 232. Top LED (4 pins) 233. Ring 234. Side hole 235. All LED 236. Side LED 237. Ring 238. Side LED (4 pins) 239. USB power 240. Power switch 241. Power switch 242. Top LED (4 pins) 243. Ring 244. Side hole 245. All LED 246. Side LED 247. Ring 248. Side LED (4 pins) 249. USB power 250. Power switch 251. Power switch 252. Top LED (4 pins) 253. Ring 254. Side hole 255. All LED 256. Side LED 257. Ring 258. Side LED (4 pins) 259. USB power 260. Power switch 261. Power switch 262. Top LED (4 pins) 263. Ring 264. Side hole 265. All LED 266. Side LED 267. Ring 268. Side LED (4 pins) 269. USB power 270. Power switch 271. Power switch 272. Top LED (4 pins) 273. Ring 274. Side hole 275. All LED 276. Side LED 277. Ring 278. Side LED (4 pins) 279. USB power 280. Power switch 281. Power switch 282. Top LED (4 pins) 283. Ring 284. Side hole 285. All LED 286. Side LED 287. Ring 288. Side LED (4 pins) 289. USB power 290. Power switch 291. Power switch 292. Top LED (4 pins) 293. Ring 294. Side hole 295. All LED 296. Side LED 297. Ring 298. Side LED (4 pins) 299. USB power 300. Power switch 301. Power switch 302. Top LED (4 pins) 303. Ring 304. Side hole 305. All LED 306. Side LED 307. Ring 308. Side LED (4 pins) 309. USB power 310. Power switch 311. Power switch 312. Top LED (4 pins) 313. Ring 314. Side hole 315. All LED 316. Side LED 317. Ring 318. Side LED (4 pins) 319. USB power 320. Power switch 321. Power switch 322. Top LED (4 pins) 323. Ring 324. Side hole 325. All LED 326. Side LED 327. Ring 328. Side LED (4 pins) 329. USB power 330. Power switch 331. Power switch 332. Top LED (4 pins) 333. Ring 334. Side hole 335. All LED 336. Side LED 337. Ring 338. Side LED (4 pins) 339. USB power 340. Power switch 341. Power switch 342. Top LED (4 pins) 343. Ring 344. Side hole 345. All LED 346. Side LED 347. Ring 348. Side LED (4 pins) 349. USB power 350. Power switch 351. Power switch 352. Top LED (4 pins) 353. Ring 354. Side hole 355. All LED 356. Side LED 357. Ring 358. Side LED (4 pins) 359. USB power 360. Power switch 361. Power switch 362. Top LED (4 pins) 363. Ring 364. Side hole 365. All LED 366. Side LED 367. Ring 368. Side LED (4 pins) 369. USB power 370. Power switch 371. Power switch 372. Top LED (4 pins) 373. Ring 374. Side hole 375. All LED 376. Side LED 377. Ring 378. Side LED (4 pins) 379. USB power 380. Power switch 381. Power switch 382. Top LED (4 pins) 383. Ring 384. Side hole 385. All LED 386. Side LED 387. Ring 388. Side LED (4 pins) 389. USB power 390. Power switch 391. Power switch 392. Top LED (4 pins) 393. Ring 394. Side hole 395. All LED 396. Side LED 397. Ring 398. Side LED (4 pins) 399. USB power 400. Power switch 401. Power switch 402. Top LED (4 pins) 403. Ring 404. Side hole 405. All LED 406. Side LED 407. Ring 408. Side LED (4 pins) 409. USB power 410. Power switch 411. Power switch 412. Top LED (4 pins) 413. Ring 414. Side hole 415. All LED 416. Side LED 417. Ring 418. Side LED (4 pins) 419. USB power 420. Power switch 421. Power switch 422. Top LED (4 pins) 423. Ring 424. Side hole 425. All LED 426. Side LED 427. Ring 428. Side LED (4 pins) 429. USB power 430. Power switch 431. Power switch 432. Top LED (4 pins) 433. Ring 434. Side hole 435. All LED 436. Side LED 437. Ring 438. Side LED (4 pins) 439. USB power 440. Power switch 441. Power switch 442. Top LED (4 pins) 443. Ring 444. Side hole 445. All LED 446. Side LED 447. Ring 448. Side LED (4 pins) 449. USB power 450. Power switch 451. Power switch 452. Top LED (4 pins) 453. Ring 454. Side hole 455. All LED 456. Side LED 457. Ring 458. Side LED (4 pins) 459. USB power 460. Power switch 461. Power switch 462. Top LED (4 pins) 463. Ring 464. Side hole 465. All LED 466. Side LED 467. Ring 468. Side LED (4 pins) 469. USB power 470. Power switch 471. Power switch 472. Top LED (4 pins) 473. Ring 474. Side hole 475. All LED 476. Side LED 477. Ring 478. Side LED (4 pins) 479. USB power 480. Power switch 481. Power switch 482. Top LED (4 pins) 483. Ring 484. Side hole 485. All LED 486. Side LED 487. Ring 488. Side LED (4 pins) 489. USB power 490. Power switch 491. Power switch 492. Top LED (4 pins) 493. Ring 494. Side hole 495. All LED 496. Side LED 497. Ring 498. Side LED (4 pins) 499. USB power 500. Power switch 501. Power switch 502. Top LED (4 pins) 503. Ring 504. Side hole 505. All LED 506. Side LED 507. Ring 508. Side LED (4 pins) 509. USB power 510. Power switch 511. Power switch 512. Top LED (4 pins) 513. Ring 514. Side hole 515. All LED 516. Side LED 517. Ring 518. Side LED (4 pins) 519. USB power 520. Power switch 521. Power switch 522. Top LED (4 pins) 523. Ring 524. Side hole 525. All LED 526. Side LED 527. Ring 528. Side LED (4 pins) 529. USB power 530. Power switch 531. Power switch 532. Top LED (4 pins) 533. Ring 534. Side hole 535. All LED 536. Side LED 537. Ring 538. Side LED (4 pins) 539. USB power 540. Power switch 541. Power switch 542. Top LED (4 pins) 543. Ring 544. Side hole 545. All LED 546. Side LED 547. Ring 548. Side LED (4 pins) 549. USB power 550. Power switch 551. Power switch 552. Top LED (4 pins) 553. Ring 554. Side hole 555. All LED 556. Side LED 557. Ring 558. Side LED (4 pins) 559. USB power 560. Power switch 561. Power switch 562. Top LED (4 pins) 563. Ring 564. Side hole 565. All LED 566. Side LED 567. Ring 568. Side LED (4 pins) 569. USB power 570. Power switch 571. Power switch 572. Top LED (4 pins) 573. Ring 574. Side hole 575. All LED 576. Side LED 577. Ring 578. Side LED (4 pins) 579. USB power 580. Power switch 581. Power switch 582. Top LED (4 pins) 583. Ring 584. Side hole 585. All LED 586. Side LED 587. Ring 588. Side LED (4 pins) 589. USB power 590. Power switch 591. Power switch 592. Top LED (4 pins) 593. Ring 594. Side hole 595. All LED 596. Side LED 597. Ring 598. Side LED (4 pins) 599. USB power 600. Power switch 601. Power switch 602. Top LED (4 pins) 603. Ring 604. Side hole 605. All LED 606. Side LED 607. Ring 608. Side LED (4 pins) 609. USB power 610. Power switch 611. Power switch 612. Top LED (4 pins) 613. Ring 614. Side hole 615. All LED 616. Side LED 617. Ring 618. Side LED (4 pins) 619. USB power 620. Power switch 621. Power switch 622. Top LED (4 pins) 623. Ring 624. Side hole 625. All LED 626. Side LED 627. Ring 628. Side LED (4 pins) 629. USB power 630. Power switch 631. Power switch 632. Top LED (4 pins) 633. Ring 634. Side hole 635. All LED 636. Side LED 637. Ring 638. Side LED (4 pins) 639. USB power 640. Power switch 641. Power switch 642. Top LED (4 pins) 643. Ring 644. Side hole 645. All LED 646. Side LED 647. Ring 648. Side LED (4 pins) 649. USB power 650. Power switch 651. Power switch 652. Top LED (4 pins) 653. Ring 654. Side hole 655. All LED 656. Side LED 657. Ring 658. Side LED (4 pins) 659. USB power 660. Power switch 661. Power switch 662. Top LED (4 pins) 663. Ring 664. Side hole 665. All LED 666. Side LED 667. Ring 668. Side LED (4 pins) 669. USB power 670. Power switch 671. Power switch 672. Top LED (4 pins) 673. Ring 674. Side hole 675. All LED 676. Side LED 677. Ring 678. Side LED (4 pins) 679. USB power 680. Power switch 681. Power switch 682. Top LED (4 pins) 683. Ring 684. Side hole 685. All LED 686. Side LED 687. Ring 688. Side LED (4 pins) 689. USB power 690. Power switch 691. Power switch 692. Top LED (4 pins) 693. Ring 694. Side hole 695. All LED 696. Side LED 697. Ring 698. Side LED (4 pins) 699. USB power 700. Power switch 701. Power switch 702. Top LED (4 pins) 703. Ring 704. Side hole 705. All LED 706. Side LED 707. Ring 708. Side LED (4 pins) 709. USB power 710. Power switch 711. Power switch 712. Top LED (4 pins) 713. Ring 714. Side hole 715. All LED 716. Side LED 717. Ring 718. Side LED (4 pins) 719. USB power 720. Power switch 721. Power switch 722. Top LED (4 pins) 723. Ring 724. Side hole 725. All LED 726. Side LED 727. Ring 728. Side LED (4 pins) 729. USB power 730. Power switch 731. Power switch 732. Top LED (4 pins) 733. Ring 734. Side hole 735. All LED 736. Side LED 737. Ring 738. Side LED (4 pins) 739. USB power 740. Power switch 741. Power switch 742. Top LED (4 pins) 743. Ring 744. Side hole 745. All LED 746. Side LED 747. Ring 748. Side LED (4 pins) 749. USB power 750. Power switch 751. Power switch 752. Top LED (4 pins) 753. Ring 754. Side hole 755. All LED 756. Side LED 757. Ring 758. Side LED (4 pins) 759. USB power 760. Power switch 761. Power switch 762. Top LED (4 pins) 763. Ring 764. Side hole 765. All LED 766. Side LED 767. Ring 768. Side LED (4 pins) 769. USB power 770. Power switch 771. Power switch 772. Top LED (4 pins) 773. Ring 774. Side hole 775. All LED 776. Side LED 777. Ring 778. Side LED (4 pins) 779. USB power 780. Power switch 781. Power switch 782. Top LED (4 pins) 783. Ring 784. Side hole 785. All LED 786. Side LED 787. Ring 788. Side LED (4 pins) 789. USB power 790. Power switch 791. Power switch 792. Top LED (4 pins) 793. Ring 794. Side hole 795. All LED 796. Side LED 797. Ring 798. Side LED (4 pins) 799. USB power 800. Power switch 801. Power switch 802. Top LED (4 pins) 803. Ring 804. Side hole 805. All LED 806. Side LED 807. Ring 808. Side LED (4 pins) 809. USB power 810. Power switch 811. Power switch 812. Top LED (4 pins) 813. Ring 814. Side hole 815. All LED 816. Side LED 817. Ring 818. Side LED (4 pins) 819. USB power 820. Power switch 821. Power switch 822. Top LED (4 pins) 823. Ring 824. Side hole 825. All LED 826. Side LED 827. Ring 828. Side LED (4 pins) 829. USB power 830. Power switch 831. Power switch 832. Top LED (4 pins) 833. Ring 834. Side hole 835. All LED 836. Side LED 837. Ring 838. Side LED (4 pins) 839. USB power 840. Power switch 841. Power switch 842. Top LED (4 pins) 843. Ring 844. Side hole 845. All LED 846. Side LED 847. Ring 848. Side LED (4 pins) 849. USB power 850. Power switch 851. Power switch 852. Top LED (4 pins) 853. Ring 854. Side hole 855. All LED 856. Side LED 857. Ring 858. Side LED (4 pins) 859. USB power 860. Power switch 861. Power switch 862. Top LED (4 pins) 863. Ring 864. Side hole 865. All LED 866. Side LED 867. Ring 868. Side LED (4 pins) 869. USB power 870. Power switch 871. Power switch 872. Top LED (4 pins) 873. Ring 874. Side hole 875. All LED 876. Side LED 877. Ring 878. Side LED (4 pins) 879. USB power 880. Power switch 881. Power switch 882. Top LED (4 pins) 883. Ring 884. Side hole 885. All LED 886. Side LED 887. Ring 888. Side LED (4 pins) 889. USB power 890. Power switch 891. Power switch 892. Top LED (4 pins) 893. Ring 894. Side hole 895. All LED 896. Side LED 897. Ring 898. Side LED (4 pins) 899. USB power 900. Power switch 901. Power switch 902. Top LED (4 pins) 903. Ring 904. Side hole 905. All LED 906. Side LED 907. Ring 908. Side LED (4 pins) 909. USB power 910. Power switch 911. Power switch 912. Top LED (4 pins) 913. Ring 914. Side hole 915. All LED 916. Side LED 917. Ring 918. Side LED (4 pins) 919. USB power 920. Power switch 921. Power switch 922. Top LED (4 pins) 923. Ring 924. Side hole 925. All LED 926. Side LED 927. Ring 928. Side LED (4 pins) 929. USB power 930. Power switch 931. Power switch 932. Top LED (4 pins) 933. Ring 934. Side hole 935. All LED 936. Side LED 937. Ring 938. Side LED (4 pins) 939. USB power 940. Power switch 941. Power switch 942. Top LED (4 pins) 943. Ring 944. Side hole 945. All LED 946. Side LED 947. Ring 948. Side LED (4 pins) 949. USB power 950. Power switch 951. Power switch 952. Top LED (4 pins) 953. Ring 954. Side hole 955. All LED 956. Side LED 957. Ring 958. Side LED (4 pins) 959. USB power 960. Power switch 961. Power switch 962. Top LED (4 pins) 963. Ring 964. Side hole 965. All LED 966. Side LED 967. Ring 968. Side LED (4 pins) 969. USB power 970. Power switch 971. Power switch 972. Top LED (4 pins) 973. Ring 974. Side hole 975. All LED 976. Side LED 977. Ring 978. Side LED (4 pins) 979. USB power 980. Power switch 981. Power switch 982. Top LED (4 pins) 983. Ring 984. Side hole 985. All LED 986. Side LED 987. Ring 988. Side LED (4 pins) 989. USB power 990. Power switch 991. Power switch 992. Top LED (4 pins) 993. Ring 994. Side hole 995. All LED 996. Side LED 997. Ring 998. Side LED (4 pins) 999. USB power 1000. Power switch 1001. Power switch 1002. Top LED (4 pins) 1003. Ring 1004. Side hole 1005. All LED 1006. Side LED 1007. Ring 1008. Side LED (4 pins) 1009. USB power 1010. Power switch 1011. Power switch 1012. Top LED (4 pins) 1013. Ring 1014. Side hole 1015. All LED 1016. Side LED 1017. Ring 1018. Side LED (4 pins) 1019. USB power 1020. Power switch 1021. Power switch 1022. Top LED (4 pins) 1023. Ring 1024. Side hole 1025. All LED 1026. Side LED 1027. Ring 1028. Side LED (4 pins) 1029. USB power 1030. Power switch 1031. Power switch 1032. Top LED (4 pins) 1033. Ring 1034. Side hole 1035. All LED 1036. Side LED 1037. Ring 1038. Side LED (4 pins) 1039. USB power 1040. Power switch 1041. Power switch 1042. Top LED (4 pins) 1043. Ring 1044. Side hole 1045. All LED 1046. Side LED 1047. Ring 1048. Side LED (4 pins) 1049. USB power 1050. Power switch 1051. Power switch 1052. Top LED (4 pins) 1053. Ring 1054. Side hole 1055. All LED 1056. Side LED 1057. Ring 1058. Side LED (4 pins) 1059. USB power 1060. Power switch 1061. Power switch 1062. Top LED (4 pins) 1063. Ring 1064. Side hole 1065. All LED 1066. Side LED 1067. Ring 1068. Side LED (4 pins) 1069. USB power 1070. Power switch 1071. Power switch 1072. Top LED (4 pins) 1073. Ring 1074. Side hole 1075. All LED 1076. Side LED 1077. Ring 1078. Side LED (4 pins) 1079. USB power 1080. Power switch 1081. Power switch 1082. Top LED (4 pins) 1083. Ring 1084. Side hole 1085. All LED 1086. Side LED 1087. Ring 1088. Side LED (4 pins) 1089. USB power 1090. Power switch 1091. Power switch 1092. Top LED (4 pins) 1093. Ring 1094. Side hole 1095. All LED 1096. Side LED 1097. Ring 1098. Side LED (4 pins) 1099. USB power 1100. Power switch 1101. Power switch 1102. Top LED (4 pins) 1103. Ring 1104. Side hole 1105. All LED 1106. Side LED 1107. Ring 1108. Side LED (4 pins) 1109. USB power 1110. Power switch 1111. Power switch 1112. Top LED (4 pins) 1113. Ring 1114. Side hole 1115. All LED 1116. Side LED 1117. Ring 1118. Side LED (4 pins) 1119. USB power 1120. Power switch 1121. Power switch 1122. Top LED (4 pins) 1123. Ring 1124. Side hole 1125. All LED 1126. Side LED 1127. Ring 1128. Side LED (4 pins)

